

NOTE(S):  
1. PART NUMBER, "/00" DENOTES PART SHALL HAVE FINISH.

2. APPLY NSF COMPLIANT GREASE TO ANY O-RING, SEALING JOINTS, AND/OR PIVOTAL POINTS.

3. APPLY NSF COMPLIANT LOCTITE TO THREADED AREA.

4. APPLY NSF COMPLIANT REMOVABLE (BLUE) LOCTITE TO THREADED AREA.

5. SILVER SOLDER JOINTS SHALL BE FULLY WETTED VIA CAPILLARY ACTION AND COMPLETELY NON-POROUS.



ITEM NO.	PART NUMBER	DESCRIPTION	QTY.	
1	11003	SLEEVE MOUNT, WALL MT WIDESPREAD	2	
2	3-418/00	WALL TUB, SPOUT ONLY, 7-1/2" L, BASIC	1	
2.1	90119	O-RING, 15/16"ID X 1-1/8"OD X 3/32"THK, AS-568-119	1	
2.2	90129	O-RING, 1-9/16"ID X 3/32"THK, AS-568-129	1	
2.3	P19018/00	7-1/2" WALL LAV SPOUT, BASIC SERIES	1	
2.4	P19017/00	ESCUTCHEON, FOR SPOUT	1	
2.5	P05024	AERATOR CACHE COIN SLOT, M21.5X1.0 FULL FLOW	1	
3	3-581/00	HANDLE LEVER W/ SET SCREW, TRANSITION	2	
4	3-590/00	ESCUTCHEON W/ SET SCREW, TRANSITION	2	
5	90029	O-RING, 1-5/8"ID X 1-3/4"OD X 1/16"THK, AS-568-029	2	

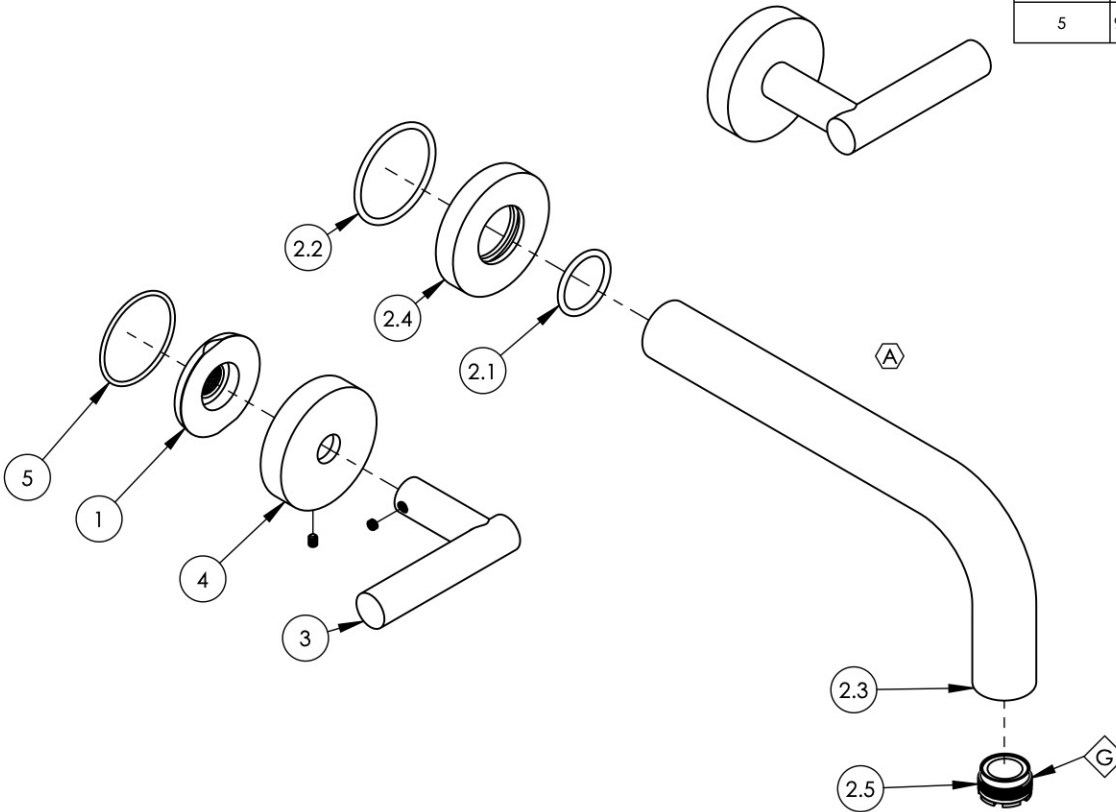

C3	A	UPDATE SPOUT ASSEMBLY	11/2/2021	AMM
ZONE	REV.	DESCRIPTION	DATE	APPROVED
REVISIONS				

1261 LOGAN AVENUE  
COSTA MESA, CALIFORNIA 92626  
PHONE: 714.361.4800  
FAX: 714.617.3120

**PHYLIRICH**<sup>®</sup>  
Defining Luxury Since 1959

**PROPRIETARY AND CONFIDENTIAL**  
THE INFORMATION CONTAINED IN THIS DRAWING  
IS THE SOLE PROPERTY OF PHYLIRICH. ANY  
REPRODUCTION IN PART OR AS A WHOLE  
WITHOUT THE WRITTEN PERMISSION OF PHYLIRICH  
IS PROHIBITED.  
**DO NOT SCALE DRAWING**

**WALL TUB SET, SPOUT 7-1/2" W/ LEVER,  
TRANSITION**

SIZE <b>A</b>	ASM/PRT NO. <b>120-57/00</b>	REV <b>A</b>
SCALE: 1:3	WEIGHT: lbs.	SHEET 1 OF 2